

**KALFIRE**  
FIREPLACES



**E**one

Holographic  
fireplaces

BIG BOOK

# Kalfire E-one Assortment

**E one**  
zero emission,  
endless possibilities

## GLASS SIZES



**BUILT-IN MODEL - FRONT** >



**BUILT-IN MODEL - CORNER** >



**BUILT-IN MODEL - 3-SIDED** >



**FREESTANDING MODEL** >

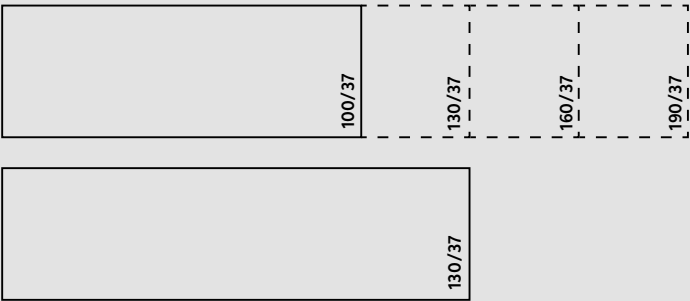

width/height (cm)

### KALFIRE E-ONE

The Kalfire E-one fireplace is powered solely by electric. With the use of patented technology, flames are projected onto individually hand-painted ceramic logs. It is truly a piece of artistic engineering, resulting in an ultra-realistic electric fire experience.

### BUILT-IN MODEL

The range of Kalfire E-one holographic fireplaces consists mostly of built-in models. Thanks to the clean lines and compact dimensions, these models are ideally suited for installation into bespoke furniture such as a feature wall in a living room, restaurant or hotel.

### FREESTANDING MODEL

The freestanding Kalfire E-one 100F FR has an all-round clean and sleek steel casing on the outside and therefore fits effortlessly into any type of interior, from modern to classical, and from rural to urban. The Kalfire E-one 100F FR is easy to install and move, which makes it possible to continue to enjoy the fireplace even after re-decorating, renovating or moving to a new home.



# E one

zero emission,  
endless possibilities



## LOG RETAINER

The Kalfire E-one corner and 3-sided models come standard with a steel trim (log retainer) around the combustion chamber.

## HD FLAME TECHNOLOGY

Through HD Flame Technology, flames are projected onto the ceramic logs.



Dual HD Flame Technology

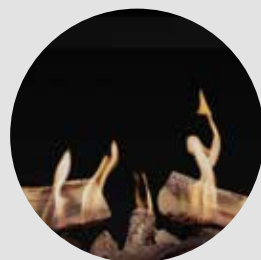

Single HD Flame Technology

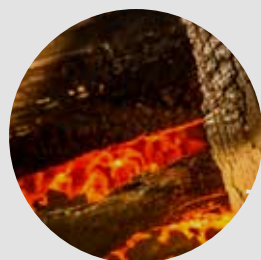

## HYBRID LED E

The Hybrid LED E ember bed simulates a real glowing bed of a fire by means of advanced and energy efficient LEDs.



## ATMOS HEATING

Atmos Heating provides a pleasant atmospheric warmth that contributes to an optimal fire experience.



Realistic ceramic logs that are undistinguishable from real wood logs.

## BOTTOM PLATES

The E-one comes as standard with a flat bottom plate. This fits perfectly in a minimalist interior and gives the fireplace a sleek appearance. Alternatively, Kalfire's design bottom plate can be chosen.



Design bottom plate

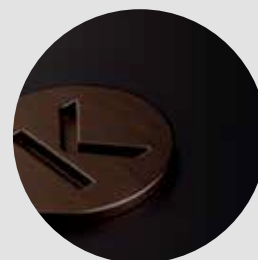

Flat bottom plate

## Cornerstones holographic fireplaces

### INDIVIDUALITY



### CREATE YOUR OWN FIRE

Thanks to innovative techniques, a flame image can be created that suits the individual taste and mood of the user. Using the remote control or, for some models the Kalfire Connected App, the flame height, flame dynamics and colour of the flames can be adjusted, as well as the

intensity of the ember bed and the ambient light. In addition to these visual settings, the sound (type and volume) can also be adjusted to taste.

### OPTIONS

The different options complete the possibilities to create your own fireplace.



## Flame options

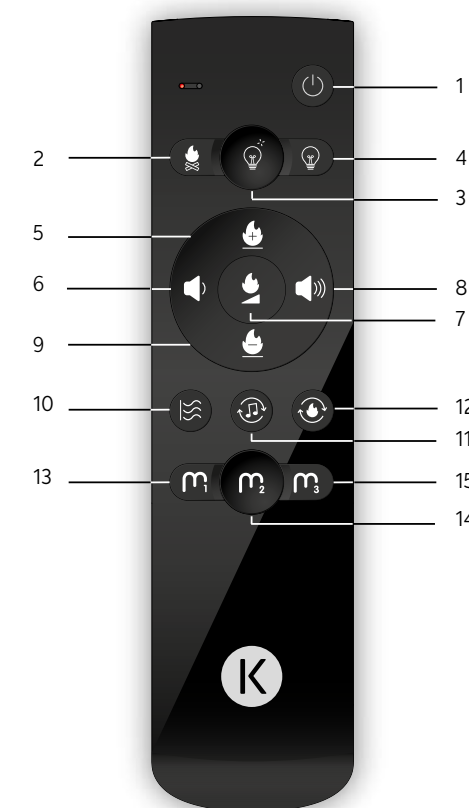

### 1. ANTI-REFLECT FUNCTION

In the Anti-Reflect stand-by function, the interior of the fireplace is attractively illuminated. This guarantees a beautiful view of the logs, even when the fireplace is not burning.

### 2. HYBRID LED E

Atmos Lighting projects true shadow effects on the wood-effect ceramic logs, enhancing the ultra-realistic fire experience. The intensity is adjustable from positions 1 to 5. The 6th position is the Atmos Lighting Shuffle mode.

### 3-4. ATMOS LIGHTING

Atmos Lighting projects a shadow effect on the logs. It enhances the real experience of fire. The intensity is adjustable from positions 1 to 5. Setting 6 is the shuffle setting.

### 5 & 9. ADJUSTABLE FLAME HEIGHT

The flame height is adjustable from positions 1 to 5. The 6th position is the Flame Shuffle mode. In Flame Shuffle mode, dynamic flames are created at the touch of a button.

### 6 & 8. VOLUME (KALFIRE SOUND) HIGHER/LOWER FIRE INTENSITY

The Fire Intensity feature allows you to adjust the brightness of the Kalfire E-one flames to match the ambient light of the room.

### 10. ATMOS HEATING

Atmos Heating is a unique heat element, specially developed for the E-one. The element delivers a pleasant heat at an angle of 45 degrees, so that the heat is distributed evenly throughout the room. Available as an option on the Kalfire E-one built-in models.

### 11. KALFIRE SOUND

Choice of two sounds: the sound of full crackling larch wood or quieter beech wood. The volume is adjustable from positions 1 to 5.

### 12. FLAME TONES

Choice of three flame colours and the ability to customize the intensity of the flames.

### 13-15. MOODS

Preprogrammed settings.



# Cornerstones holographic fireplaces

## EXPERIENCE



The Kalfire E-one stimulates the senses. The flickering of light, the glowing logs and coal, the floating sparks and the playfulness of the flames. The sound of crackling wood. A feeling of warmth radiating from the flames. The unique features of Kalfire's E-one provide a realistic atmosphere in and around the fireplace.



### SEE

Through HD Flame Technology, an ultra realistic fire is created with true, full flames, sparks and high definition flame effects. A feast for the eyes.



### FEEL

Atmos Heating is exclusively available for the built-in models of the Kalfire E-one. The heating element has been specially developed by Kalfire to create a natural and pleasant heat output in your home. The Atmos Heating element gives a constant flow of warm air at an angle of 45 degrees, and provides an optimal heating experience that is unique to an electric fireplace.



### HEAR

No fire experience is complete without the soothing sound of burning wood. Kalfire Sound offers the user a choice of two different sounds: crackling Pinewood or the sound of much quieter burning Beechwood. In addition, the volume can be adjusted as desired.

## EASE OF USE



### ENDLESS POSSIBILITIES

The E-one stands for freedom, with no need for chimneys or gas connections, and without having to take environmental restrictions into account. A mains socket is sufficient. This opens up a world of possibilities. The fire can be placed anywhere in the house, in apartments, restaurants, hotels, office buildings, public spaces, etc. without any problems.

Optionally, the fireplace can be equipped with a hotel switch.



### MAINTENANCE

Thanks to its fully electric operation, the E-one is very easy to maintain. It does not need to be cleaned after use (like a wood fire). It does not emit ash particles, so there is no need for annual flue or chimney maintenance. And it does not have a reservoir for fluids that needs to be refilled regularly, or a connection to a supply, as with a bioethanol fire or an electric vapor fireplace.

### SIMPLE OPERATION

The robust and ergonomic Kalfire E-one Remote guarantees easy operation. Thanks to the Live Feedback, settings are projected directly onto the screen of the fireplace. This allows you to see live which functions in the fireplace are on or off and how the flames are set. The 160 and 190 models can also be operated with the Kalfire Connected App.



# Cornerstones holographic fireplaces

## DURABILITY & SUSTAINABILITY



### ZERO EMISSIONS

The E-one is fully electric, does not use fossil fuels and has zero emissions. The Kalfire E-one therefore sets a trend in the field of innovation, sustainability and efficiency.

### LOW ENERGY CONSUMPTION

The energy consumption of the E-one is low: at around 110 Watts\*, the fireplace is particularly efficient in use. This is friendly for the home and for the environment.

*\*Exclusive Atmos Heating element and based on Dual HD Flame Technology.*

### SUSTAINABLE PACKAGING

The sustainable philosophy has been implemented down to the last detail. For example, the packaging of the E-one has been sustainably produced.



## EXPERTISE



### QUALITY AND WARRANTY

Kalfire stands for craftsmanship. The Kalfire E-one has been fully designed and developed in the Netherlands, and is also manufactured entirely on Dutch soil. We stand behind the quality of our products and, therefore the warranty period on our electric fire is five years or up to 10,000 burning hours. For the Atmos Heating function of your fire, we offer a two year warranty.

The Kalfire E-one is in constant development. We continue to work hard behind the scenes on future updates to make the product even better and more innovative. The E-one is a fire that always keeps up with new developments and market demands.



### SAFETY

Choosing an electric fire is a safe choice. After all, there is no need for a gas connection or a flue. In addition, the E-one does not give off any direct heat and is therefore safe for humans and animals, even the smallest. Everyone can gather around the fireplace, care-free, and experience the connective force of fire.







Kalfire E-one 100F



Kalfire E-one 130S



Kalfire E-one 100F



Kalfire E-one 100F FR





# Kalfire E-one 100F

SCAN ME



## Kalfire E-one 100F

Top view

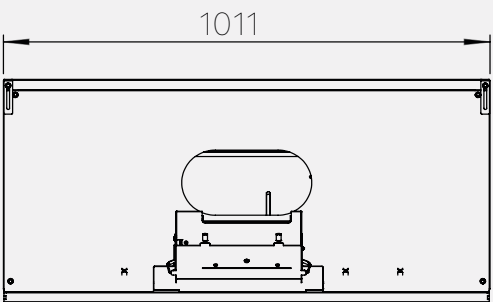

Front view

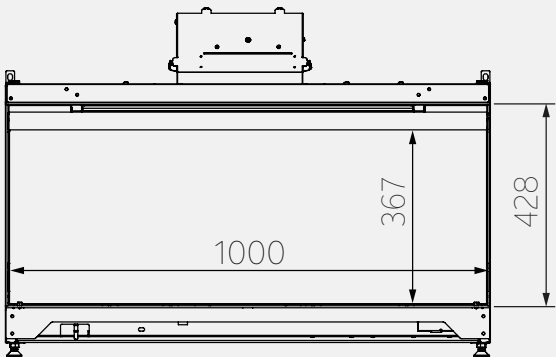

Side view

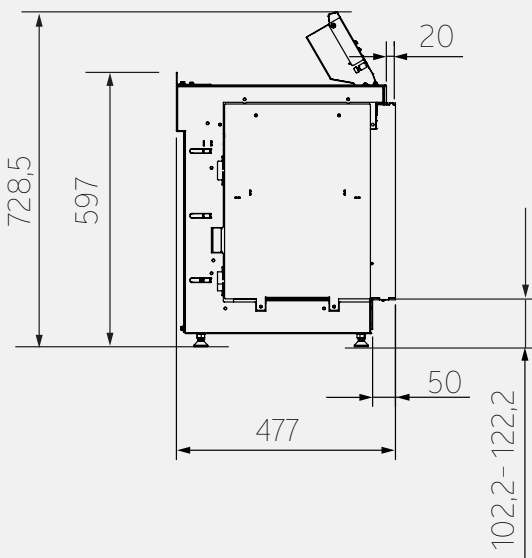

### Technical information

#### Energy consumption per operation mode

Stand-by mode (W)	11
Stand-by mode, incl. Anti-Reflect Function (W)	23
Full operating mode*, excl. Atmos Heating (W)	116
Full operating mode*, incl. Atmos Heating- level 1 (W)	1115
Full operating mode*, incl. Atmos Heating - level 2 (W)	2115

\* full operating mode: hybrid LED E, Kalfire Sound, Flame Tones, Flame Height, Atmos Lighting and Anti-Reflect Function at the highest level.

### Product information

#### Model

Front, built-in

#### Connections

220-240 VAC - 50Hz 13 A

#### Input

220-240 VAC - 50Hz 13 A

#### Operation

Operation via remote control  
and Kalfire Connected App

#### Glass Size (mm)

Width:	1000
Height:	367

#### Product Weight(kg)

Single HD Flame Technology with flat bottom plate:	100
Dual HD Flame Technology with design bottom plate:	105

### Components (standard model)

- Fireplace module (metal frame, electronic box (E-box), glass reflector, hybrid Led E, ceramic logs )
- Single HD Flame Technology
- Flat bottom plate
- Mounting trim (2 cm deep, 4 mm thick)
- Remote control
- Power cable
- Relay connector

### Options

- Dual HD Flame Technology
- Design bottom plate
- Atmos Heating (adjustable 2 levels, max 2 kW)



SCAN ME

## Kalfire E-one 100S



### Technical information

#### Energy consumption per operation mode

Stand-by mode (W)	11
Stand-by mode, incl. Anti-Reflect Function (W)	23
Full operating mode*, excl. Atmos Heating (W)	116
Full operating mode*, incl. Atmos Heating- level 1 (W)	1115
Full operating mode*, incl. Atmos Heating - level 2 (W)	2115

\* full operating mode: hybrid LED E, Kalfire Sound, Flame Tones, Flame Height, Atmos Lighting and Anti-Reflect Function at the highest level.

### Product information

#### Model

3-sided, built-in

#### Connections

220-240 VAC - 50Hz 13 A

#### Input

220-240 VAC - 50Hz 13 A

#### Operation

Operation via remote control  
and Kalfire Connected App

### Glass Size (mm)

Width:	1020
Height:	367
Width side glass:	344

### Product Weight (kg)

Dual HD Flame Technology with design bottom plate:	100
---	-----

### Components (standard model)

- Fireplace module (metal frame, electronic box (E-box), glass reflector, log retainer, hybrid Led E, ceramic logs )
- Dual HD Flame Technology
- Flat bottom plate
- Mounting trim (3.5 cm deep, 4 mm thick)
- Remote control
- Power cable
- Relay connector

### Options

- Design bottom plate
- Atmos Heating (adjustable 2 levels, max 2 kW)

## Kalfire E-one 100S

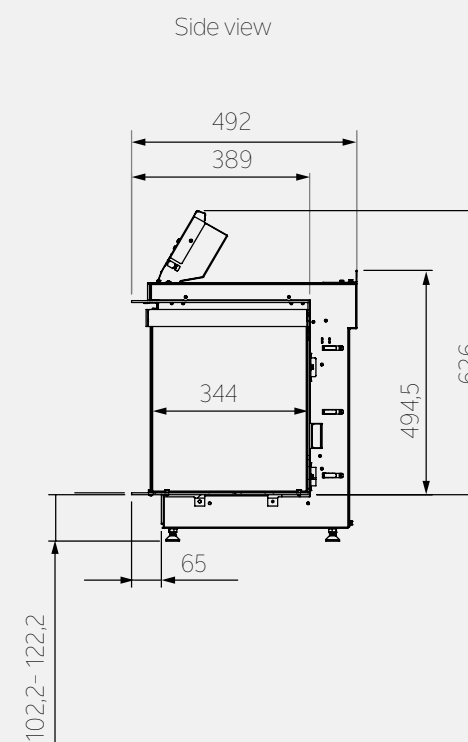
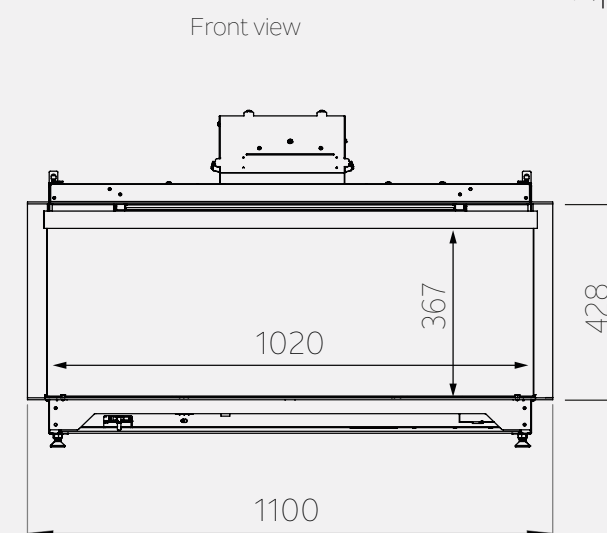
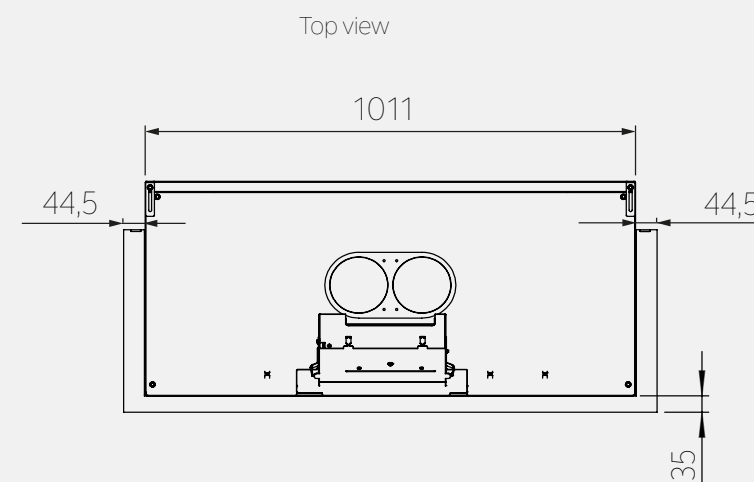





SCAN ME

## Kalfire E-one 100F *FR*



### Technical information

#### Energy consumption per operation mode

Stand-by mode (W)	11
Stand-by mode, incl. Anti-Reflect Function (W)	23
Full operating mode*, Single HD Flame technology, (W)	56
Full operating mode*, Dual HD Flame technology (W)	116

\* full operating mode: hybrid LED E, Kalfire Sound, Flame Tones, Flame Height, Atmos Lighting and Anti-Reflect Function at the highest level.

### Product information

#### Model

front, freestanding

#### Connections

220-240 VAC - 50Hz 13 A

#### Input

220-240 VAC - 50Hz 13 A

#### Operation

Operation via remote control  
and Kalfire Connected App

### Glass Size (mm)

Width:	1000
Height:	367

### Product Weight (kg)

Single HD Flame Technology with flat bottom plate	137
Dual HD Flame Technology with design bottom plate	142

### Components (standard model)

- Fireplace module (metal frame, electronic box (E-box), glass reflector, hybrid Led E, ceramic logs )
- Black metal hood,
- Single HD Flame Technology
- Flat bottom plate
- Remote control
- Power cable
- Relay connector

### Options

- Dual HD Flame Technology
- Design bottom plate
- Atmos Heating (adjustable 2 levels, max 2 kW)

## Kalfire E-one 100F *FR*

Top view

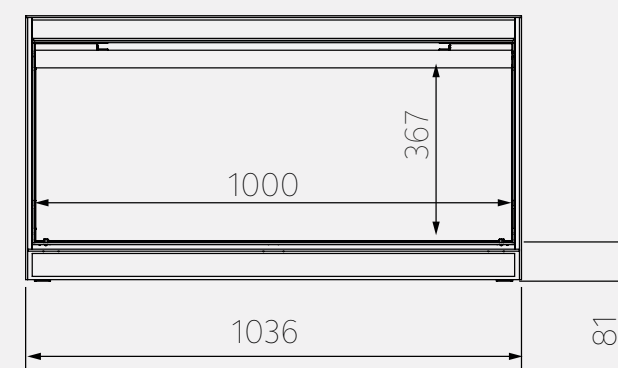

Back view

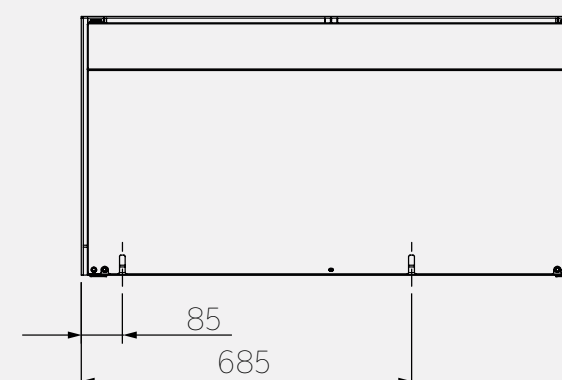

Side view

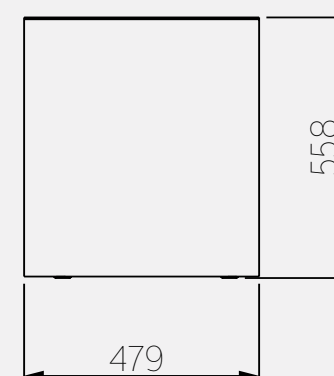





SCAN ME

## Kalfire E-one 130F



### Technical information

#### Energy consumption per operation mode

Stand-by mode (W)	11
Stand-by mode, incl. Anti-Reflect Function (W)	23
Full operating mode*, excl. Atmos Heating (W)	116
Full operating mode*, incl. Atmos Heating- level 1 (W)	1115
Full operating mode*, incl. Atmos Heating - level 2 (W)	2115

\* full operating mode: hybrid LED E, Kalfire Sound, Flame Tones, Flame Height, Atmos Lighting and Anti-Reflect Function at the highest level.

#### Product information

##### Model

front, built-in

##### Connections

220-240 VAC - 50Hz 13 A

##### Input

220-240 VAC - 50Hz 13 A

##### Operation

Operation via remote control  
and Kalfire Connected App

#### Glass Size (mm)

Width:	1300
Height:	367

#### Product Weight (kg)

Dual HD Flame Technology with design bottom plate:	135
---	-----

#### Components (standard model)

- Fireplace module (metal frame, electronic box (E-box), glass reflector, hybrid Led E, ceramic logs )
- Dual HD Flame Technology
- Flat bottom plate
- Mounting trim (2 cm deep, 4 mm thick)
- Remote control
- Power cable
- Relay connector

#### Options

- Design bottom plate
- Atmos Heating (adjustable 2 levels, max 2 kW)

## Kalfire E-one 130F

Top view

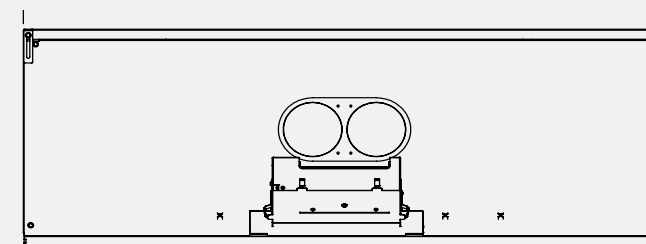

Front view

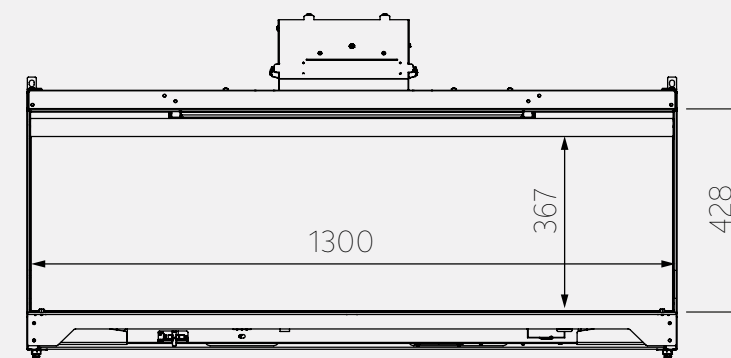

Side view

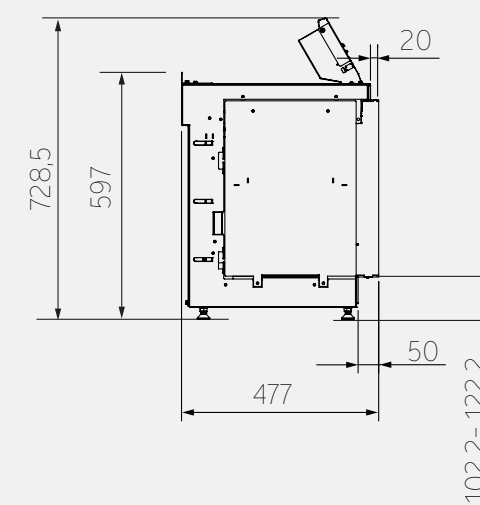





SCAN ME

## Kalfire E-one 130C



### Technical information

#### Energy consumption per operation mode

Stand-by mode (W)	11
Stand-by mode, incl. Anti-Reflect Function (W)	23
Full operating mode*, excl. Atmos Heating (W)	116
Full operating mode*, incl. Atmos Heating- level 1 (W)	1115
Full operating mode*, incl. Atmos Heating - level 2 (W)	2115

\* full operating mode: hybrid LED E, Kalfire Sound,  
Flame Tones, Flame Height, Atmos Lighting and  
Anti-Reflect Function at the highest level.

### Product information

#### Model

corner left or right, built-in

#### Connections

220-240 VAC - 50Hz 13 A

#### Input

220-240 VAC - 50Hz 13 A

#### Operation

Operation via remote control  
and Kalfire Connected App

### Glass Size (mm)

Width:	1300
Height:	367
Width side glass:	344

### Product Weight (kg)

Dual HD Flame Technology with design bottom plate:	128
---	-----

### Components (standard model)

- Fireplace module (metal frame, electronic box (E-box), glass reflector, log retainer, hybrid Led E, ceramic logs )
- Dual HD Flame Technology
- Flat bottom plate
- Mounting trim (3.5 cm deep, 4 mm thick)
- Remote control
- Power cable
- Relay connector

### Options

- Design bottom plate
- Atmos Heating (adjustable 2 levels, max 2 kW)

## Kalfire E-one 130CL

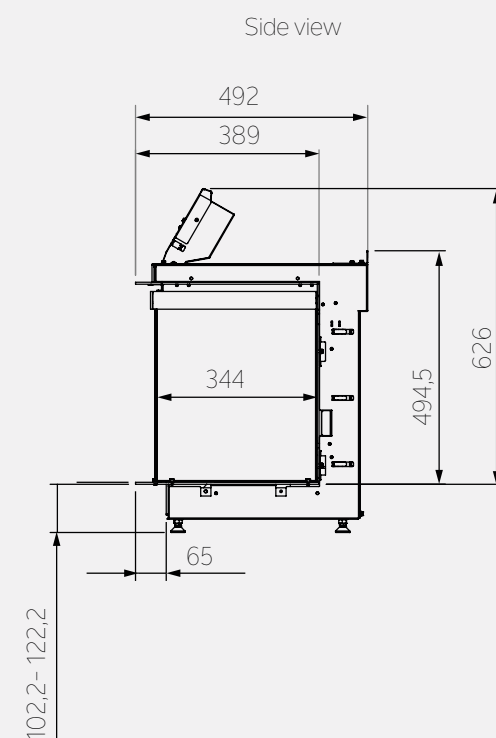
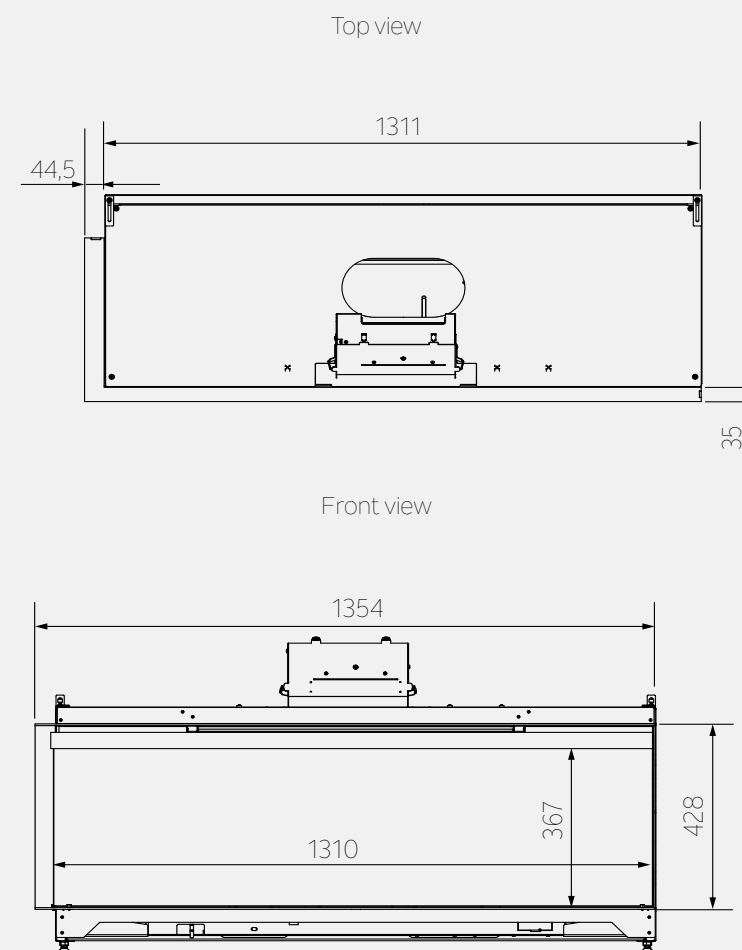

## Kalfire E-one 130CR

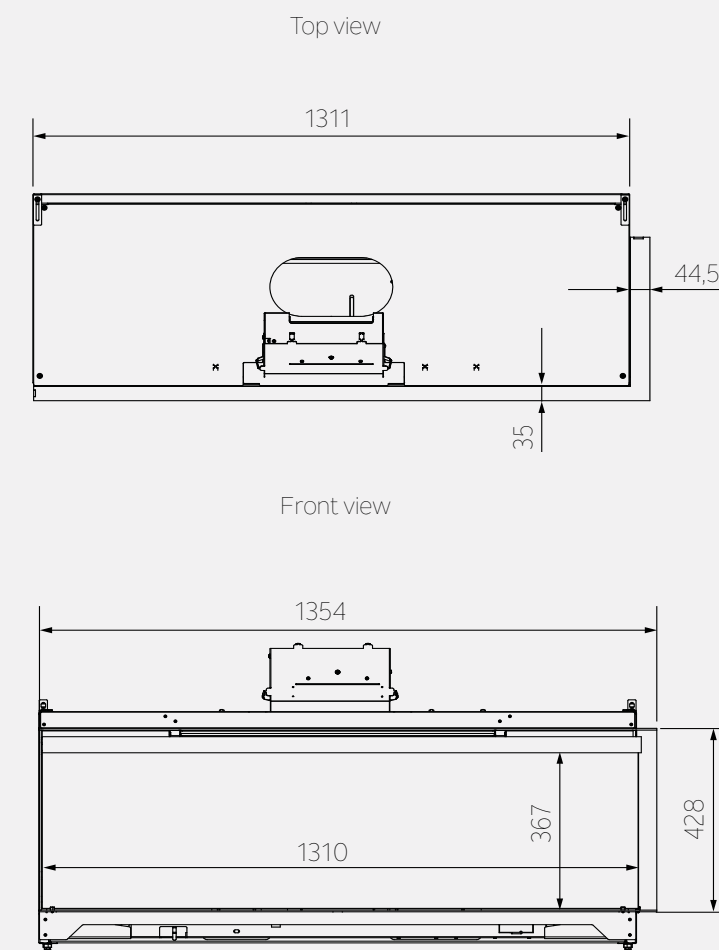





# Kalfire E-one 130S

SCAN ME



## Kalfire E-one 130S

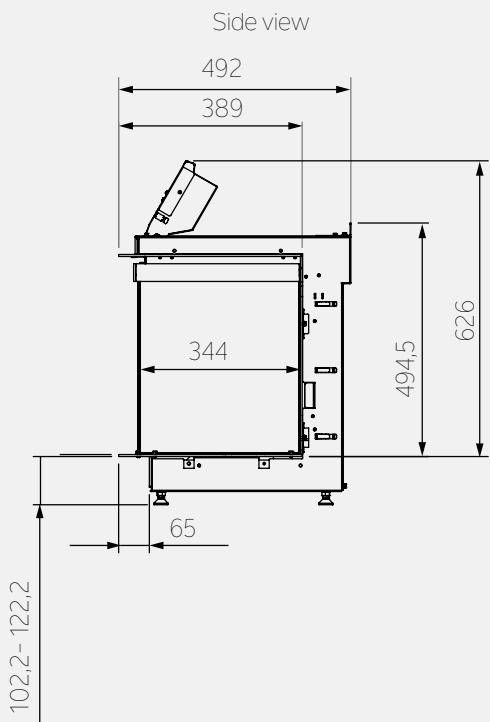
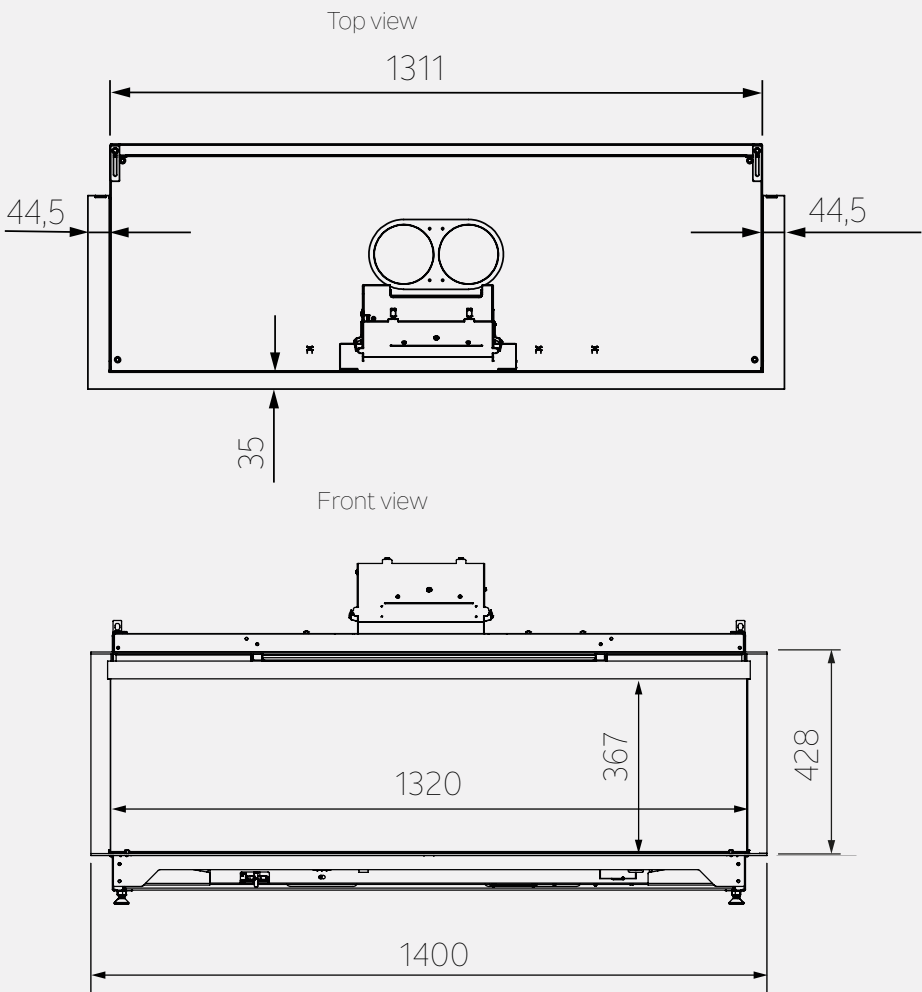

### Technical information

#### Energy consumption per operation mode

Stand-by mode (W)	11
Stand-by mode, incl. Anti-Reflect Function (W)	23
Full operating mode*, excl. Atmos Heating (W)	116
Full operating mode*, incl. Atmos Heating- level 1 (W)	1115
Full operating mode*, incl. Atmos Heating - level 2 (W)	2115

\* full operating mode: hybrid LED E, Kalfire Sound, Flame Tones, Flame Height, Atmos Lighting and Anti-Reflect Function at the highest level.

### Product information

#### Model

3-sided, built-in

#### Connections

220-240 VAC - 50Hz 13 A

#### Input

220-240 VAC - 50Hz 13 A

#### Operation

Operation via remote control  
and Kalfire Connected App

#### Glass Size (mm)

Width:	1320
Height:	367
Width side glass:	344

#### Product Weight (kg)

Dual HD Flame Technology with design bottom plate:	130
---	-----

### Components (standard model)

- Fireplace module (metal frame, electronic box (E-box), glass reflector, log retainer, hybrid Led E, ceramic logs )
- Dual HD Flame Technology
- Flat bottom plate
- Mounting trim (3.5 cm deep, 4 mm thick)
- Remote control
- Power cable
- Relay connector

### Options

- Design bottom plate
- Atmos Heating (adjustable 2 levels, max 2 kW)





# Kalfire E-one 160F

SCAN ME



## Kalfire E-one 160F

Top view

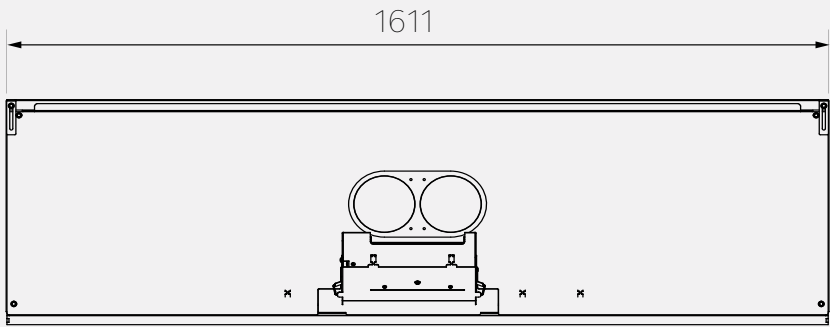

Front view

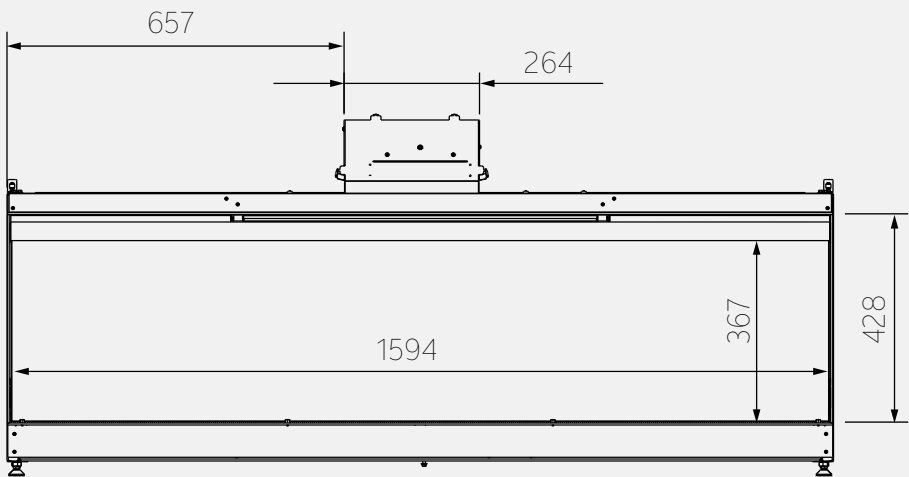

Side view

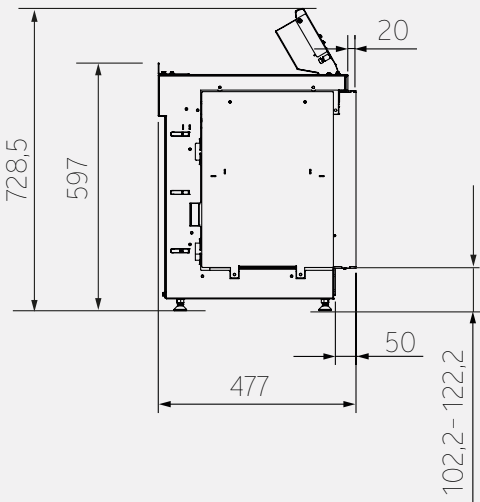

### Technical information

#### Energy consumption per operation mode

Stand-by mode (W)	11
Stand-by mode, incl. Anti-Reflect Function (W)	23
Full operating mode*, excl. Atmos Heating (W)	116
Full operating mode*, incl. Atmos Heating- level 1 (W)	1115
Full operating mode*, incl. Atmos Heating - level 2 (W)	2115

\* full operating mode: hybrid LED E, Kalfire Sound, Flame Tones, Flame Height, Atmos Lighting and Anti-Reflect Function at the highest level.

### Product information

#### Model

front, built-in

#### Connections

220-240 VAC - 50Hz 13 A

#### Input

220-240 VAC - 50Hz 13 A

#### Operation

Operation via remote control  
and Kalfire Connected App

#### Glass Size (mm)

Width:	1594
Height:	367

#### Product Weight (kg)

Kalfire E-160F	
with flat bottom plate:	160
with design bottom plate:	165

### Components (standard model)

- Fireplace module (metal frame, electronic box (E-box), glass reflector, hybrid Led E, ceramic logs )
- Dual HD Flame Technology
- Flat bottom plate
- Mounting trim (2 cm deep, 4 mm thick)
- Relay connector
- Remote control
- Power cable

### Options

- Design bottom plate
- Atmos Heating (adjustable 2 levels, max 2 kW)



SCAN ME

## Kalfire E-one 160S

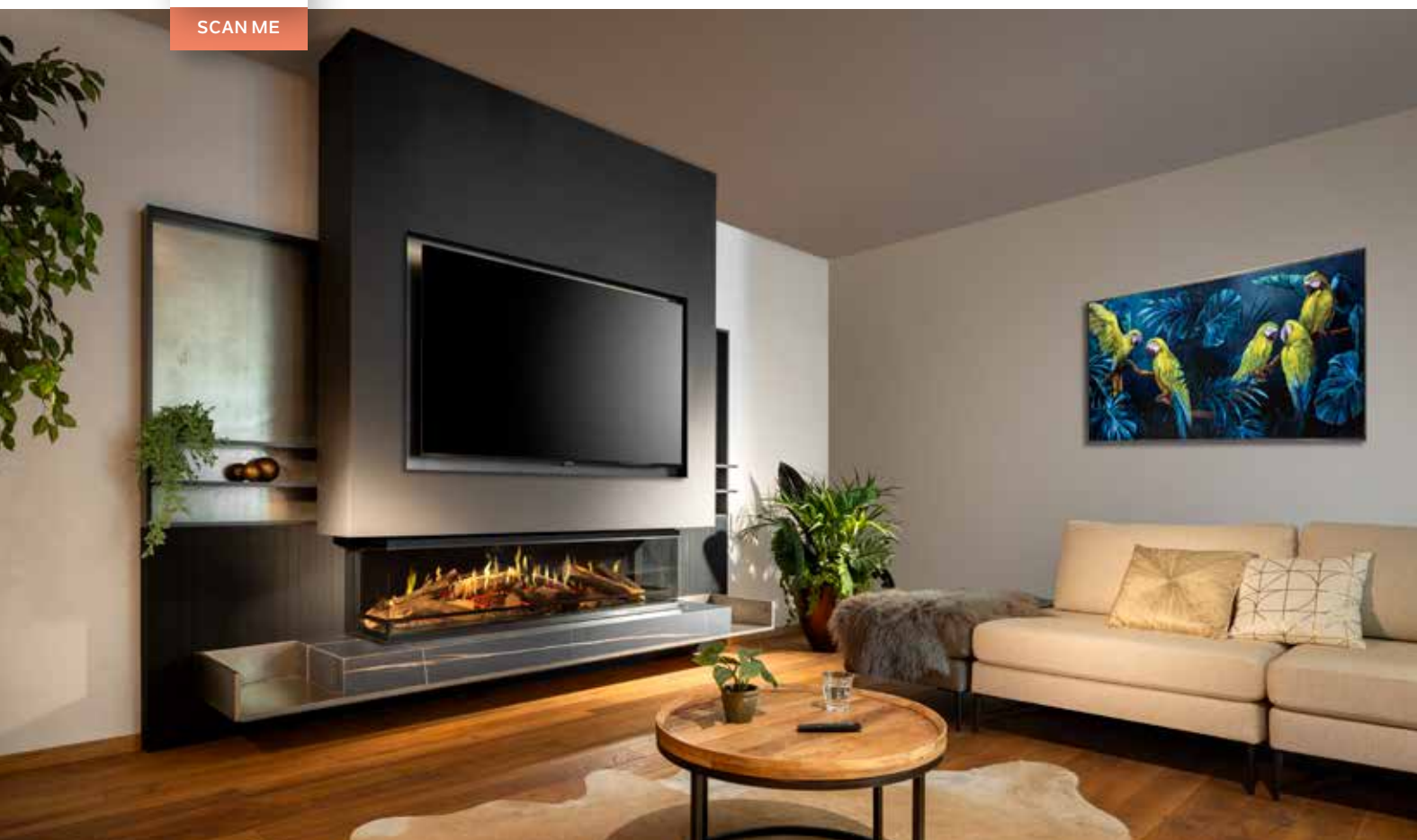

## Kalfire E-one 160S

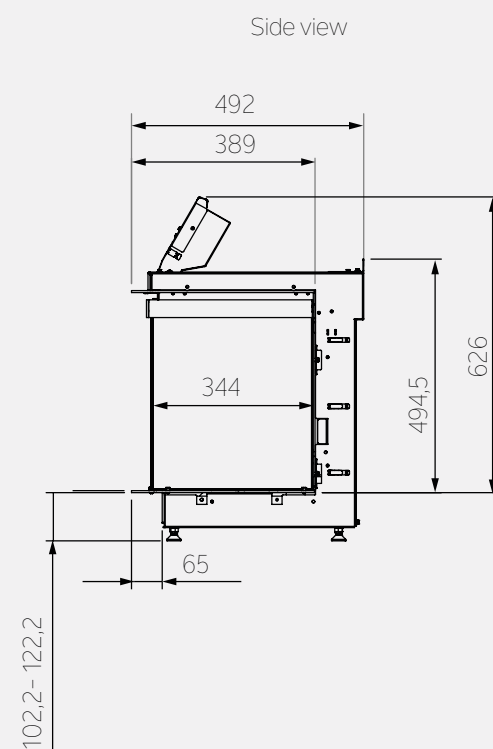
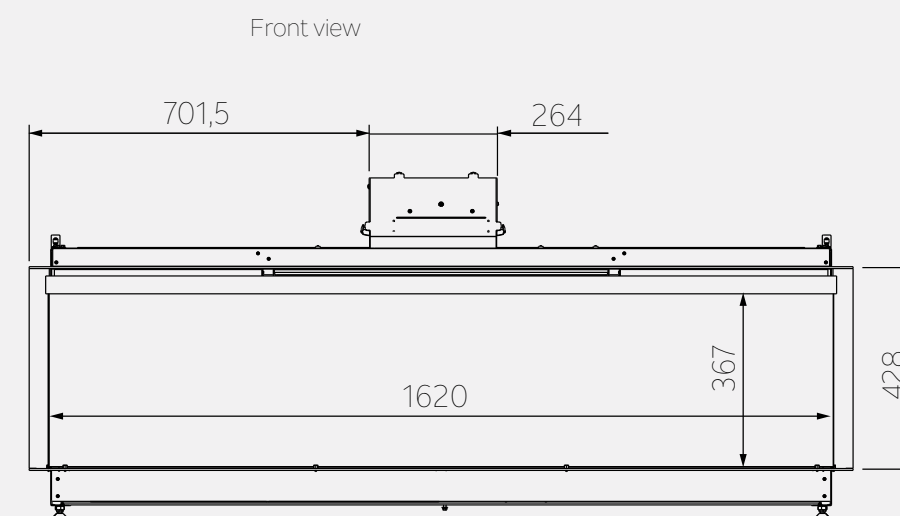
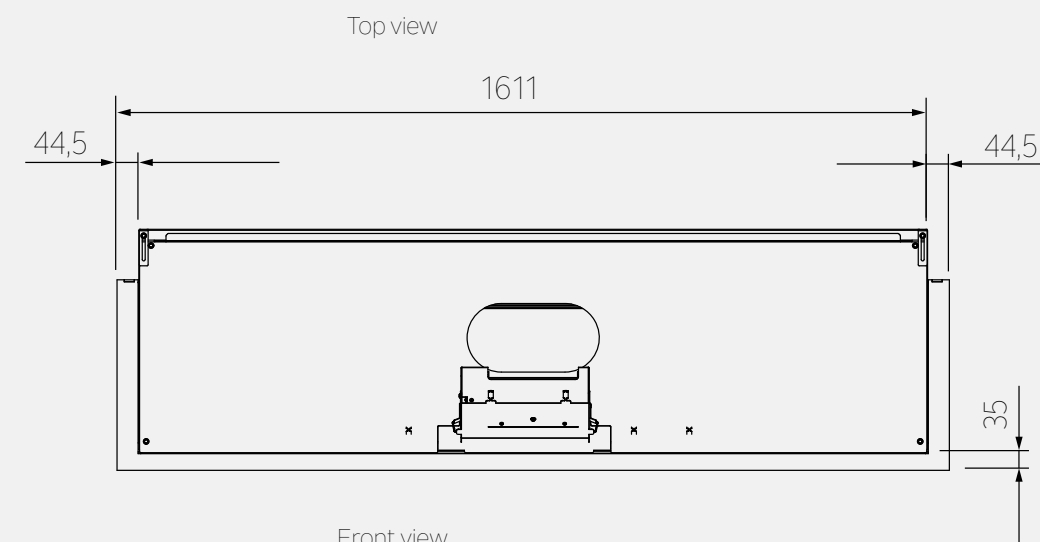

### Technical information

#### Energy consumption per operation mode

Stand-by mode (W)	11
Stand-by mode, incl. Anti-Reflect Function (W)	23
Full operating mode*, excl. Atmos Heating (W)	116
Full operating mode*, incl. Atmos Heating- level 1 (W)	1115
Full operating mode*, incl. Atmos Heating - level 2 (W)	2115

\* full operating mode: hybrid LED E, Kalfire Sound, Flame Tones, Flame Height, Atmos Lighting and Anti-Reflect Function at the highest level.

### Product information

#### Model

3-sided, built-in

#### Connections

220-240 VAC - 50Hz 13 A

#### Input

220-240 VAC - 50Hz 13 A

#### Operation

Operation via remote control  
and Kalfire Connected App

### Glass Size (mm)

Width:	1620
Height:	367
Width side glass:	344

### Product Weight (kg)

Kalfire E-160S with flat bottom plate:	150
with design bottom plate:	155

### Components (standard model)

- Fireplace module (metal frame, log retainer, electronic box (E-box), glass reflector, log hybrid Led E, ceramic logs)
- Dual HD Flame Technology
- Flat bottom plate
- Mounting trim (3.5 cm deep, 4 mm thick)
- Relay connector
- Remote control
- Power cable

### Options

- Design bottom plate
- Atmos Heating (adjustable 2 levels, max 2 kW)





SCAN ME

## Kalfire E-one 190F



### Technical information

#### Energy consumption per operation mode

Stand-by mode (W)	11
Stand-by mode, incl. Anti-Reflect Function (W)	23
Full operating mode*, excl. Atmos Heating (W)	116
Full operating mode*, incl. Atmos Heating- level 1 (W)	1115
Full operating mode*, incl. Atmos Heating - level 2 (W)	2115

\* full operating mode: hybrid LED E, Kalfire Sound, Flame Tones, Flame Height, Atmos Lighting and Anti-Reflect Function at the highest level.

### Product information

#### Model

front, built-in

#### Connections

220-240 VAC - 50Hz 13 A

#### Input

220-240 VAC - 50Hz 13 A

#### Operation

Operation via remote control  
and Kalfire Connected App

### Glass Size (mm)

Width:	1896
Height:	367

### Product Weight (kg):

Kalfire E-190F	
with flat bottom plate:	180
with design bottom plate:	185

### Components (standard model)

- Fireplace module (metal frame, electronic box (E-box), glass reflector, hybrid Led E, ceramic logs )
- Dual HD Flame Technology
- Flat bottom plate
- Mounting trim (2 cm deep, 4 mm thick)
- Relay connector
- Remote control
- Power cable

### Options

- Design bottom plate
- Atmos Heating (adjustable 2 levels, max 2 kW)

## Kalfire E-one 190F

Top view

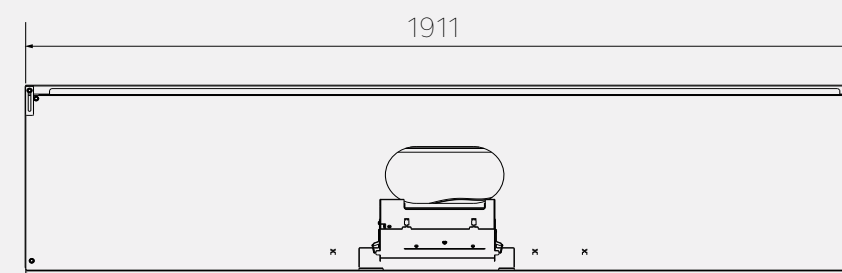

Front view

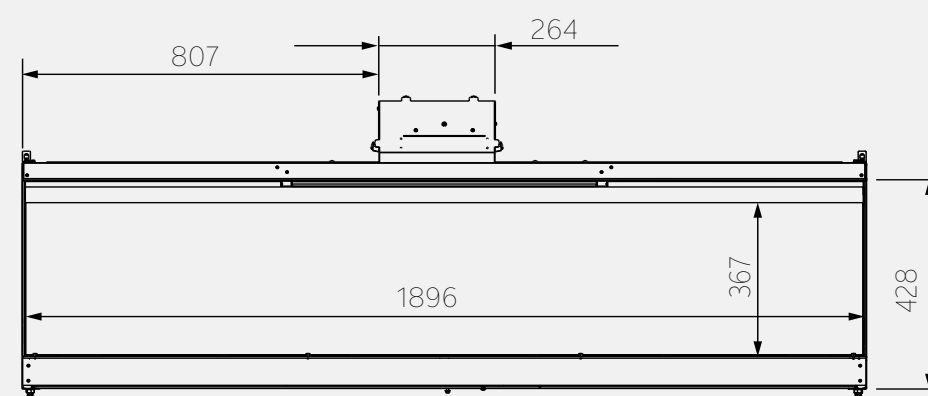

Side view

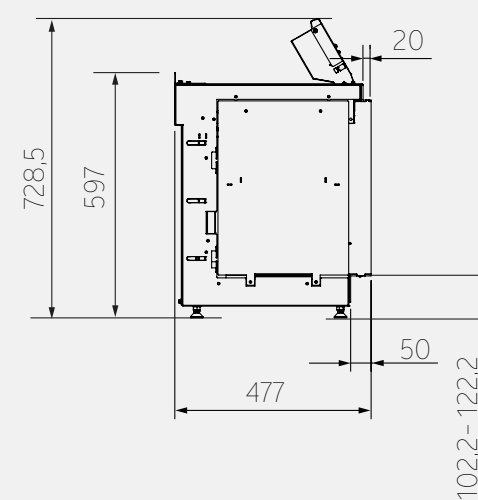



# Kalfire E-one 190S

SCAN ME

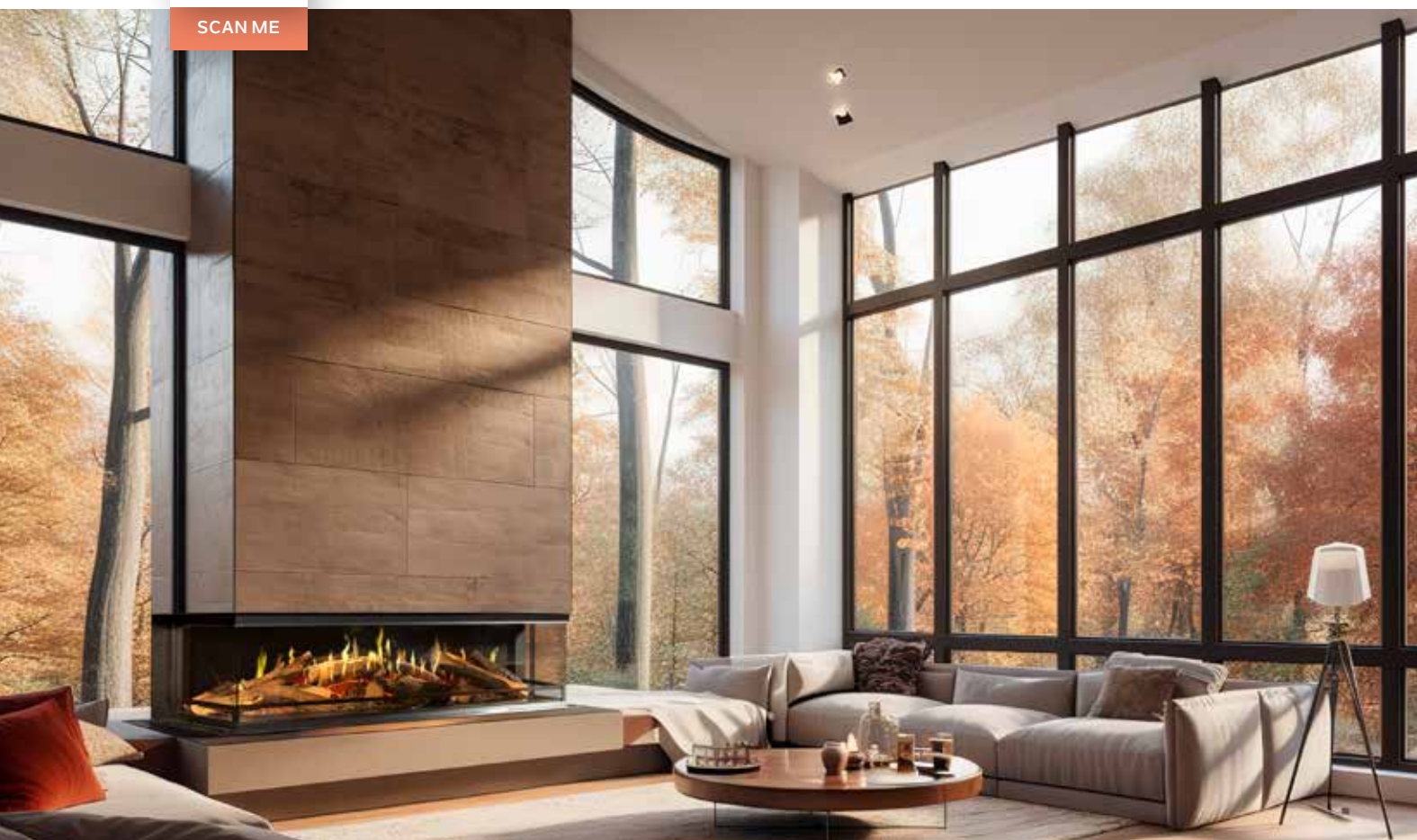

## Kalfire E-one 190S

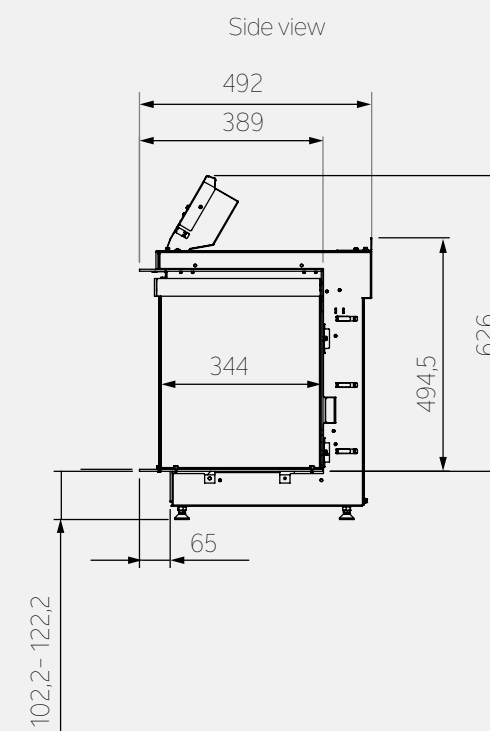
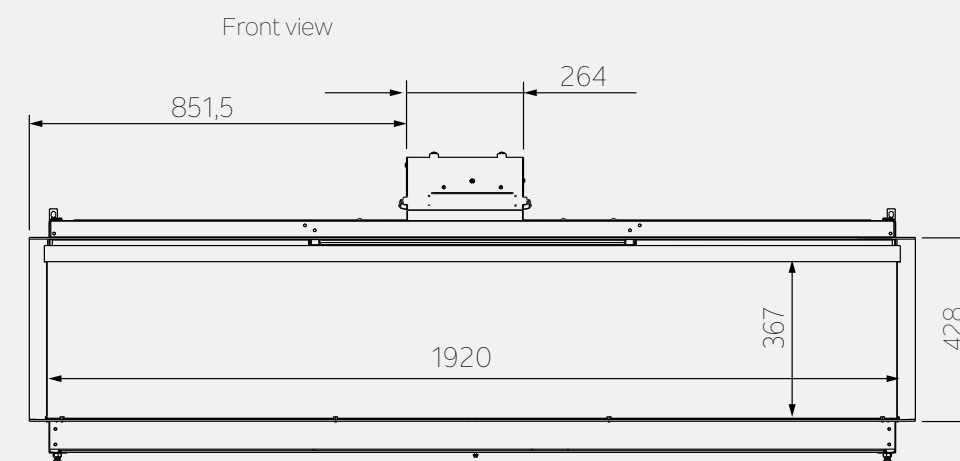
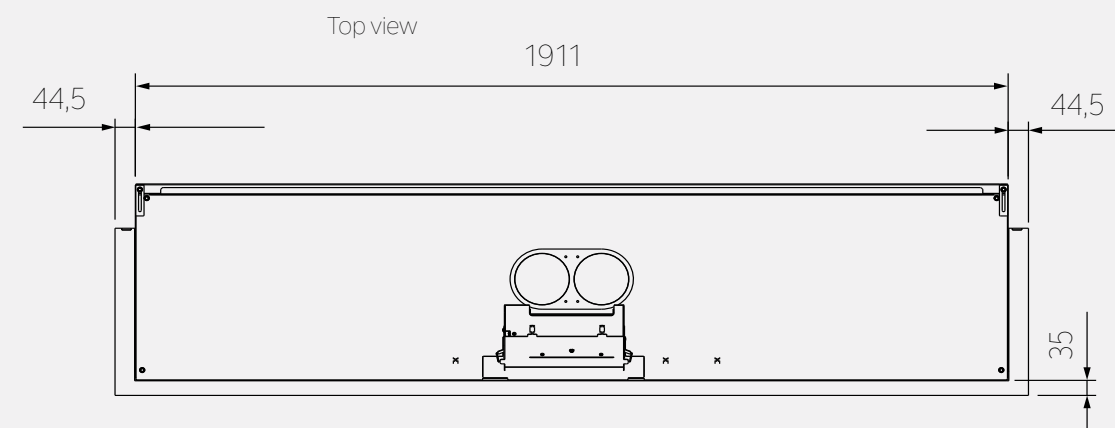

### Technical information

#### Energy consumption per operation mode

Stand-by mode (W)	11
Stand-by mode, incl. Anti-Reflect Function (W)	23
Full operating mode*, excl. Atmos Heating (W)	116
Full operating mode*, incl. Atmos Heating- level 1 (W)	1115
Full operating mode*, incl. Atmos Heating - level 2 (W)	2115

\* full operating mode: hybrid LED E, Kalfire Sound, Flame Tones, Flame Height, Atmos Lighting and Anti-Reflect Function at the highest level.

### Product information

#### Model

3-sided, built-in

#### Connections

220-240 VAC - 50Hz 13 A

#### Input

220-240 VAC - 50Hz 13 A

#### Operation

Operation via remote control  
and Kalfire Connected App

### Glass Size (mm)

Width:	1920
Height:	367
Width side glass:	344

### Product Weight (kg)

Kalfire E-190S with flat bottom plate:	175
with design bottom plate:	180

### Components (standard model)

- Fireplace module (metal frame, electronic box (E-box), glass reflector, log retainer, hybrid Led E, ceramic logs )
- Dual HD Flame Technology
- Flat bottom plate
- Mounting trim (3.5 cm deep), 4 mm thick
- Relay connector
- Remote control
- Power cable

### Options

- Design bottom plate
- Atmos Heating (adjustable 2 levels, max 2 kW)





Kalfire E-one 130C



**KALFIRE**  
FIREPLACES

CONNECTING  
PEOPLE  
THROUGH  
SUSTAINABLE  
FIRE.

Geloërveldweg 21  
5951 DH Belfeld - NL

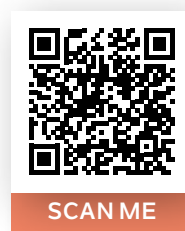

info@kalfire.com  
**KALFIRE.COM**